

abbotFox



Maidstone Road, Norwich  
*£800 PCM*

“

We are a team of genuine individuals who hold a deep passion for both property and marketing. Collectively, we bring over 70 years of experience in the property market of Norfolk and Suffolk. Our affection for both counties runs deep, and we are enthusiastic about sharing our passion with you.

Colin McKenzie | **Branch Partner**





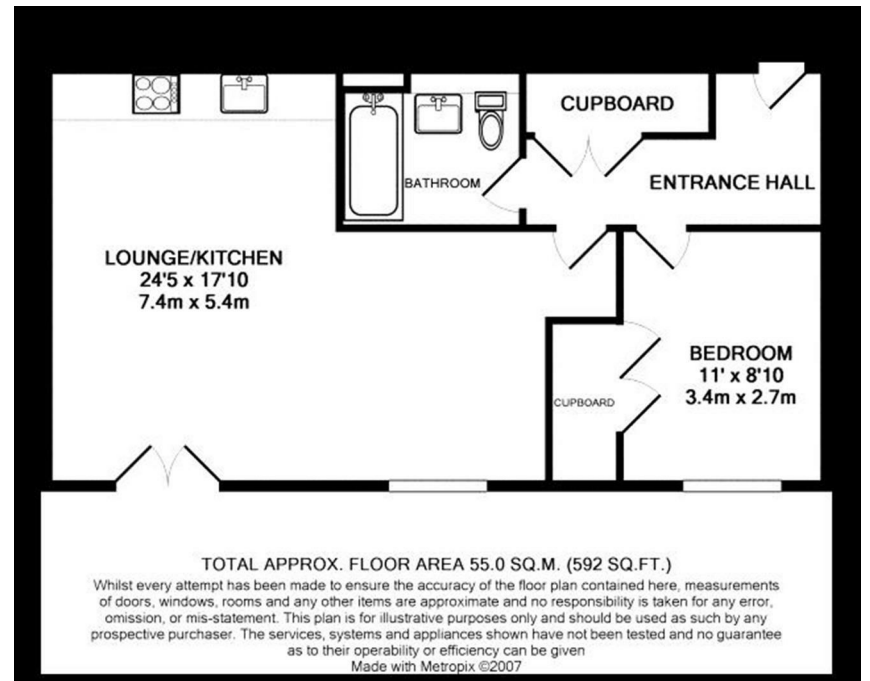

## THE DETAIL \_\_\_\_\_

**\*\*\*UNDERGROUND PARKING\*\*\*** abbotFox presents this property in the heart of the City Centre, this second floor apartment offers open plan living, one double bedroom, secure entry system, private garden and underground parking. Set in the much sought after Maidstone Road development within walking distance of the city centre with its wide range of high street shops, shopping malls, pubs, popular restaurants and the historical Norman castle and cathedral.



## THE HIGHLIGHTS \_\_\_\_\_

- Secure underground parking
- Modern open-planned living
- Furnished
- Juliet balcony
- Lots of natural light
- High levels of interest expected

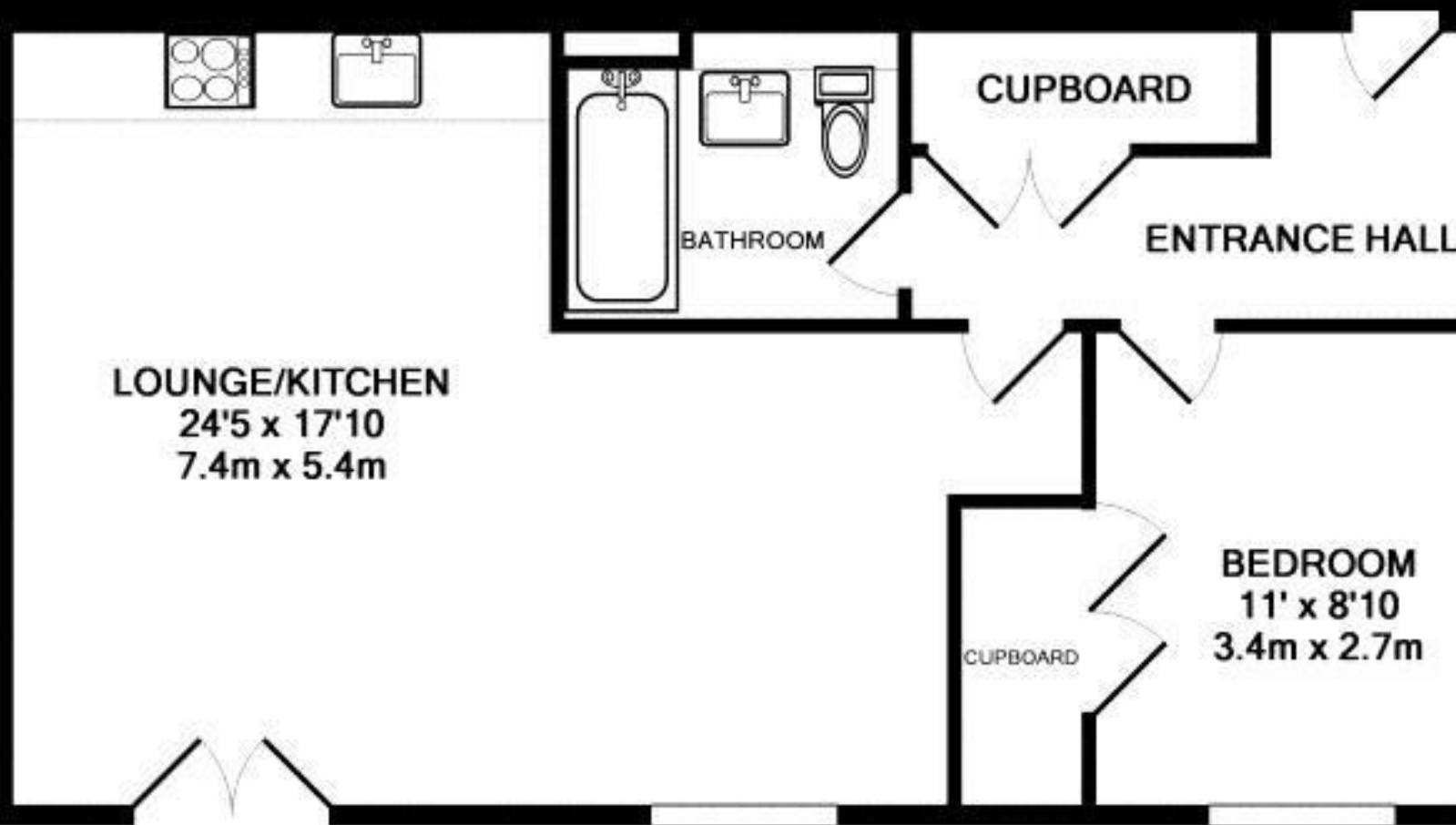

**TOTAL APPROX. FLOOR AREA 55.0 SQ.M. (592 SQ.FT.)**

Whilst every attempt has been made to ensure the accuracy of the floor plan contained here, measurements of doors, windows, rooms and any other items are approximate and no responsibility is taken for any error, omission, or mis-statement. This plan is for illustrative purposes only and should be used as such by any prospective purchaser. The services, systems and appliances shown have not been tested and no guarantee as to their operability or efficiency can be given

Made with Metropix ©2007

Let

01603 660000

sales@abbotfox.co.uk

@abbotfox

EPC RATING -

Disclaimer – In accordance with the Property Misdescriptions Act, the company abbotFox gives notice that all descriptions, references to condition, necessary permissions for use and other details are given in good faith and believed to be correct, but any purchaser should not rely on them as statements of fact, and must satisfy themselves by inspection or other means, as to their accuracy.